

IP 68

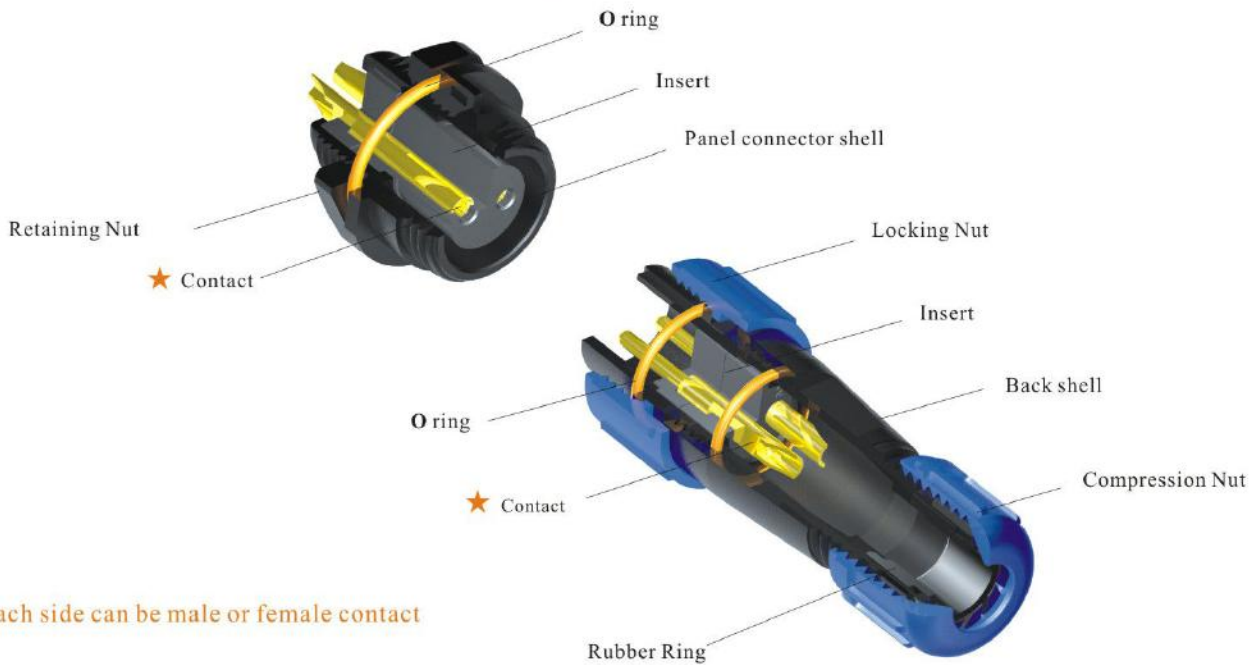

● **SP13 & SP21 IP68 Threaded coupling**



★ Each side can be male or female contact

Material and spec

Coupling	Threaded coupling			
Shell material	Nylon66 , fire resistance : V-0			
Insert material	PPS max temperature 260 °C			
Contact material	Brass with gold plating			
Termination	SP13: solder		SP21: solder / screw	
Cable outer diameter range	SP13 I: 4-6.5mm	II: 5-8mm	SP21 I: 4.5-7mm	II: 7-12mm
IP rating	IP68			
Mating cycle	>500			
Temperature range	-25°C ~ +85°C			
Insulation resistance MΩ	2000			

SP21 Series IP68

**SP
21**



Cable connector
Mate with SP2111, SP2112, SP2113

SP2110 / P --- SP2110 / S
Number of contact

C: with cap
N: without cap
I: solder, 2: screw, 3: crimp
Cable outer diameter: I: 4.5-7mm, II: 7-12mm

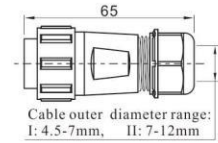
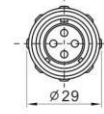

In-line cable connector
Mate with SP2110

SP2111 / P --- SP2111 / S

C: with cap
N: without cap

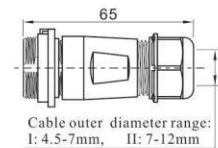
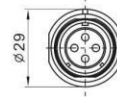

Rear-nut mount
Mate with SP2110

SP2112 / P --- SP2112 / S
Number of contact

C: with cap
N: without cap
I: solder, 2: screw, 3: crimp

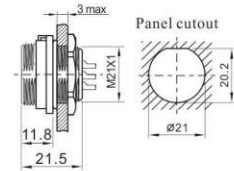
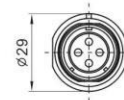

2-hole flange
Mate with SP2110

SP2113 / P --- SP2113 / S

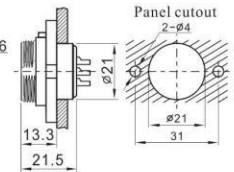
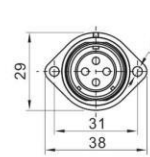

Angled cable connector
Mate with SP2111, SP2112, SP2113

SP2116 / P --- SP2116 / S
Number of contact

C: with cap
N: without cap
I: solder, 2: screw, 3: crimp
Cable outer diameter:
I: 4.5-7mm, II: 7-12mm

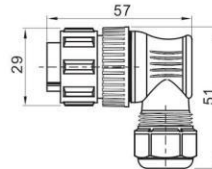

Solder contact spec

★ Crimp contact spec see page 89-92

Number of contact	2	3	4	5	5B	5C	7	9	12
Male contact face view									
Rated current (A)	30	30	30	30	30 5	15	15	5	5
Contact diameter(mm)	3	3	3	3	3 3X2 1X3	2	2	1	1
Rated voltage (AC.V)	500	500	500	500	500	500	500	500	400
Test voltage(AC.V) 1 min	1500	1500	1500	1500	1500	1500	1500	1500	1200
Contact resistance (mΩ)	1	1	1	1	1 5	2.5	2.5	5	5
Termination	Solder Screw	Solder Screw	Solder Screw	Solder Screw	Solder	Solder	Solder	Solder	Solder
Wire size for solder (mm ² / AWG)	≤4/11	≤4/11	≤4/11	≤4/11	≤4/11 ≤0.75/18	≤2/14	≤2/14	≤0.75/18	≤0.75/18
Wire size for screw termination (mm ² / AWG)	≤1.5/15	≤1.5/15	≤1.5/15	≤1.5/15	/	/	/	/	/